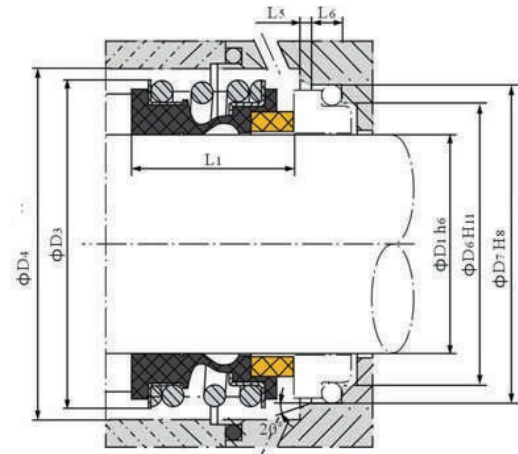

Image PIMS



PIMS Drawing



**Allowable limits**

Pressure : 1.2MPa  
 Velocity : 10m/s  
 Temperature : - 20 - 200°C

**Component materials**

Fixed ring: SIC  
 Rotating ring: SIC  
 Secondary seal: Viton  
 Spring & others: SUS304

**Application**

Used for oils, waters and other slightly corrosive fluids

**PIMS Dimension**

Model	D1	D3	D4	D6	D7	L1	L5	L6
P12IMS	12	25	26	19	23	15	1.5	4
P14IMS	14	28.5	30	21	25	17	1.5	4
P15IMS	15	28.5	30	-	-	17	-	-
P16IMS	16	28.5	30	23	27	17	1.5	4
P18IMS	18	32	33	27	33	19.5	2	5
P19IMS	19	36	38	-	-	21.5	2	5
P20IMS	20	37	38	29	35	21.5	2	5
P22IMS	22	37	38	31	37	21.5	2	5

## PIMS Dimension

Model	D1	D3	D4	D6	D7	L1	L5	L6
P24IMS	24	42.5	44	33	39	22.5	2	5
P25IMS	25	42.5	44	34	40	23	2	5
P28IMS	28	49	50	37	43	26.5	2	5
P30IMS	30	49	50	39	45	26.5	20	5
P32IMS	32	53.5	55	42	48	27.5	2	5
P33IMS	33	53.5	55	42	48	27.5	2	5
P35IMS	35	57	59	44	50	28.5	2	5
P38IMS	38	59	61	49	56	30	2	6
P40IMS	40	62	64	51	58	30	2	6
P43IMS	43	65.5	67	54	61	30	20	6
P45IMS	45	68	70	56	63	30	2	6
P48IMS	48	70.5	74	59	66	30.5	2	6
P50IMS	50	74	77	62	70	30.5	2.5	6
P53IMS	53	78.5	81	65	73	33	2.5	6
P55IMS	55	81	83	67	75	35	2.5	6
P58IMS	58	85.5	88	70	78	37	2.5	6
P60IMS	60	88.5	91	72	80	38	3	6
P65IMS	65	93.5	96	77	85	40	2.5	6
P68IMS	68	96.5	100	81	90	40	3	7
P70IMS	70	99.5	103	83	92	40	2.5	7
P75IMS	75	107	110	88	97	40	2.5	7
P80IMS	80	112	116	95	105	40	3	7
P85IMS	85	120	124	100	110	41	3	7
P90IMS	90	127	131	105	115	45	3	7
P95IMS	95	132	136	110	120	46	3	7

## PIMS Dimension

Model	D1	D3	D4	D6	D7	L1	L5	L6
P100IMS	100	137	140	115	125	47	3	4